

Tsurumi's typical slurry pumps with a 4-pole motor for an increased lifetime and greater convenience.

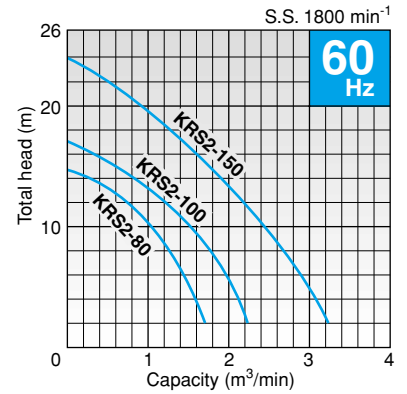

Performance Curves

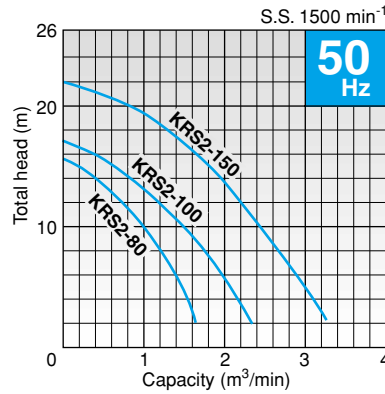

Standard Specifications 50/60Hz

Discharge Bore mm	Model	Motor Output kW	Phase	Total Head m	Capacity m³/min	Starting Method	Dry Weight kgs	Cable Length m
80	KRS2-80	4	Three-phase	10	1.0	D.O.L.	105	8
100	KRS2-100	6	Three-phase	10	1.5	D.O.L.	143	8
150	KRS2-150	9	Three-phase	15/8	1.8/2.5	D.O.L.	170/162	8

* Dry weight excluding cable

Major Standard Specifications

Item	Discharge bore size mm			
	80	100	150	
Pumping fluid	Type of fluid	Sludge, slurry, liquids containing sandy mud and/or bentonite		
	Fluid temperature	0~40°C		
Pump	Structure	Impeller	Semi-open	
		Shaft seal	Double mechanical seal	
		Bearing	Shielded ball bearing	
	Materials	Impeller	Chromium iron casting	
		Casing	Grey iron casting	
		Suction plate	Chromium iron casting	
Motor	Shaft seal (mechanical seal)	Silicon carbide		
	Type, Poles	Dry-type submersible induction motor, 4 poles		
	Insulation	Class E · B		
	Phase / Voltage	Three-phase/ 220V, 380V, 400V, 415V, 440V, 460V		
	Motor protector (Built-in)	Circle thermal protector		
	Lubricant	Turbine oil (ISO VG32)		
Materials	Frame	Grey iron casting		
	Shaft	Stainless steel #420		
	Cable	Chloroprene rubber		
Discharge connection	Hose coupling			

Dimensions

Unit: mm

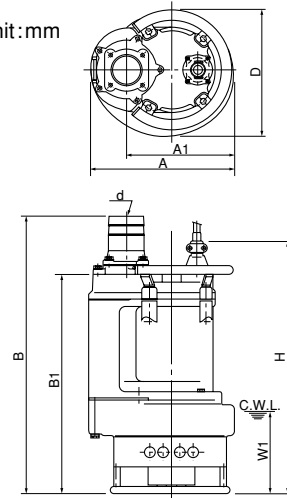

C.W.L. : Continuous Running Water Level

Model	d	A	A1	B	B1	D	H	W1
KRS2-80	80	350	260	786	666	326	766	250
KRS2-100	100	415	305	815	678	373	754	250
KRS2-150 50Hz	150	434	324	879	699	407	811	250
KRS2-150 60Hz	150	415	305	879	699	383	811	250

Standard Accessory

- Hose coupling 1pc.



Cross-Section

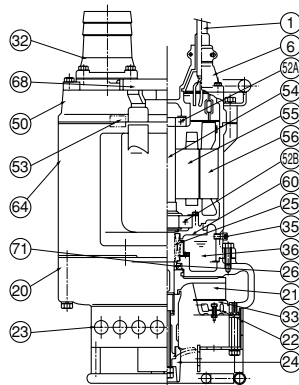

NO.	DESCRIPTIONS	NO.	DESCRIPTIONS
1	Cable	36	Lubricant
6	Stuffing Box	50	Motor Bracket
20	Pump Casing	52A	Upper Bearing
21	Impeller	52B	Lower Bearing
22	Suction Cover	53	Motor Protector
23	Strainer Stand	54	Shaft
24	Forced Agitation	55	Rotor
25	Mechanical Seal	56	Stator
26	Oil Seal	60	Bearing Housing
32	Hose Coupling	64	Motor Frame
33	Suction Plate	68	Handle
35	Oil Plug	71	Shaft Sleeve

* Oil Lifter is not illustrated.